

**FRIALEN®** -kolano W90°**PE 100 SDR 11**

Maksymalne dopuszczalne ciśnienie robocze 16 bar (woda) / 10 bar (gaz)

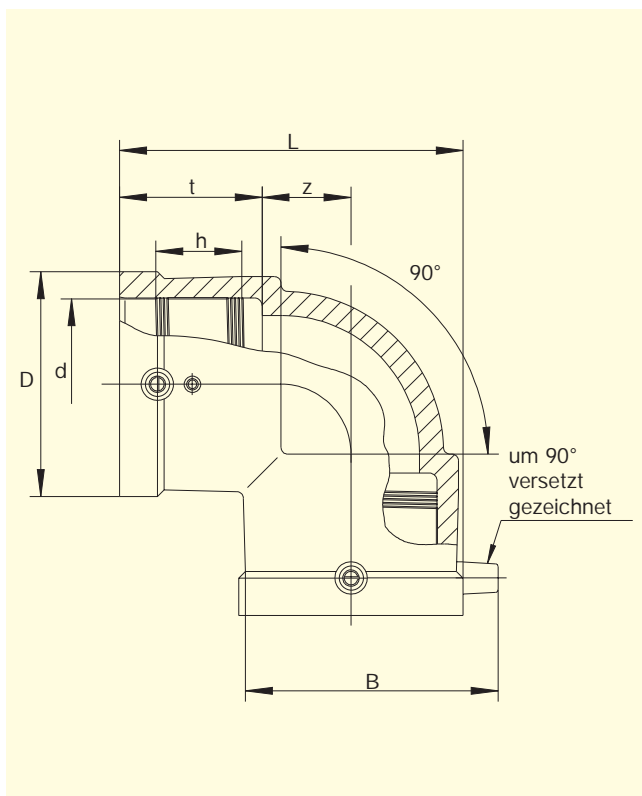

d	Best.-Nr.	Lager-status	VE	PE	D	L	t	z	h	B	Gewicht kg/St.
25	T-612 091	1	40	1.280	40	75	36,5	16	19,5	-	0,066
32	T-612-093	1	30	960	49	85	42,0	21	21,0	61,0	0,104
40	T-612 095	1	20	640	58	102	45,5	27	23,0	69,5	0,159
50	T-612 097	1	15	480	70	118	53,0	30	27,0	80,0	0,212
63	T-612 099	1	15	270	84	128	55,0	33	39,0	93,5	0,313
75	T-612 101	1	15	270	98	151	61,0	41	37,5	-	0,560
90	T-612 103	1	6	108	117	180	71,5	51	42,8	123,0	0,836
110	T-612 105	1	10	80	142	222	83,0	68	47,0	157,0	1,489
125	T-612 107	1	8	64	158	240	85,0	73	51,0	162,0	1,932
160	T-615 276	1	3	24	199	295	96,0	99	59,0	198,0	3,605
180	T-615 689	1	3	24	228	354	103,0	135	65,0	-	5,600
225	T-615 690	1	1	8	283	430	118,0	169	80,0	-	12,000

kolana W90 FRIALEN - można zgrzewać z rurami typoszeregu SDR 11 - 17.6