

Index to ABS Imperial Fittings

Note: Two-dimensional Auto-CAD drawings are available on www.durapipe.co.uk



Pipe (plain)
page 30



Sockets (plain)
page 31



O-Ring sockets
page 31

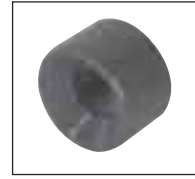

Reducing bushes
(plain)
page 31



Reducing sockets
(plain)
page 32



Elbows 45° (plain)
page 32



Elbows 90° (plain)
page 32



Tees 45° (equal plain)
page 32



Tees 90° (equal plain)
page 33



Tees 90° (swept plain)
page 33



Tees 90° (reducing)
page 33



Bends 22½°
(long radius)
page 33



Bends 45°
(long radius)
page 34



Bends 90°
(long radius)
page 34



Bends 90°
(short radius plain)
page 34



Saddles (plain)
page 35



End caps (plain)
page 35



Socket unions (plain)
page 35



Imperial/metric socket
adaptors (plain)
page 36



Sockets
(plain female BSP thread)
page 36



Reducing bushes
(plain female BSP thread)
page 36



Elbows 90°
(plain female BSP thread)
page 36



Female adaptors
(plain spigot end/female
BSP thread) page 37



Hexagon nipples male
(plain spigot/male BSP
thread) page 37



Male threaded fittings
(plain/brass male thread)
page 37



Female threaded fittings
(plain/brass female thread)
page 37



Male threaded adaptors
(plain/male BSP taper
threaded) page 38



Barrel nipples
(plain/BSP taper threaded)
page 38



Hose adaptors
(BSP taper threaded/
hose tail) page 38



Tank connectors
(plain spigot/male BSP
parallel thread) page 39



Composite unions
(plain/brass, female BSP
parallel thread) page 39



Composite unions
(plain/brass, male BSP
taper thread) page 39



Sockets
(female BSP taper
thread) page 39



Reducing bushes
(male/female BSP
thread) page 40



Elbows 90°
(female BSP taper
thread) page 40



End caps
(female BSP taper thread) page 40

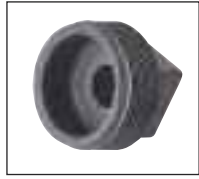

Plugs
(male BSP taper thread) page 40



Hexagon nipples
(male BSP taper thread) page 41



Back nuts
(female BSP taper thread) page 41



Flanges stub
(plain/serrated) page 41



Flanges full face
(plain/drilled) page 42



Flanges blanking
(plain/drilled) page 43



Backing rings
(galvanised mild steel drilled) page 44

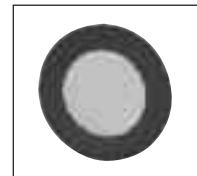

Gaskets flat
(stub flange EPDM) page 45



Gaskets full face
(drilled EPDM) page 45



Valve support plates
(galvanised mild steel) page 46



O-Ring for socket unions
(for use with socket unions) page 46

Valves



VKD Double union ball valves (manual - EPDM seals) page 47



TKD 3-way ball valves
(manual - EPDM seals) page 47



EV Double union ball valves
(manual - EPDM seals) page 48



UC Ball check valves
(plain ends - EPDM seals) page 48



UA Air release valves
(plain ends - EPDM seals) page 48



RV Y-Type strainers
(plain ends - EPDM seals) page 49



VM Diaphragm valves
(manual - plain union ends - EPDM seals) page 49



PR Pressure relief valves
(EPDM seals) page 50



FK Butterfly valves (glass reinforced polypropylene with ABS disc and EPDM seals) page 50

Accessories

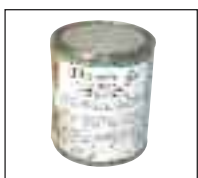

One-step solvent cement page 51



Eco-cleaner page 51



Cobra pipe clips
(polypropylene) page 51



Saddle clips
(polypropylene) page 51



Chamfering and de-burring tools page 51



Pipe cutters page 51

ABS Pipe imperial system Plain

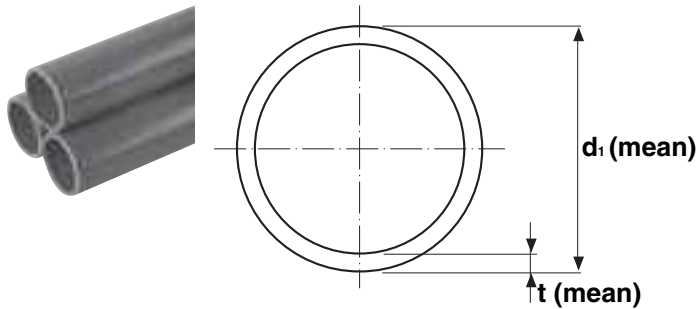

Pipe - ABS Class C 130psig (9 bar)

Size	Mean OD d_1	Thickness t (mm)	Length (m)	Weight kg/m	Code
1	33.6	2.0	6	0.21	01 511 104
1 ^{1/4}	42.2	2.5	6	0.32	01 511 105
1 ^{1/2}	48.3	2.8	6	0.42	01 511 106
2	60.3	3.6	6	0.67	01 511 107
2 ^{1/2}	75.2	5.0	6	1.14	11 551 312
3	88.9	5.2	6	1.40	01 511 109
4	114.3	6.6	6	2.32	01 511 110
5	140.2	9.3	6	3.97	11 551 316
6	168.3	9.9	6	5.12	01 511 112
8	219.1	12.7	6	8.57	01 511 113

*Note: 2^{1/2}" & 5" pipes dimensionally compatible with 75mm and 140mm PN10 Metric series and are manufactured in accordance with the general requirements of DIN 8061/8062.

Pipe - ABS Class D 173psig (12 bar)

Size	Mean OD d_1	Thickness t (mm)	Length (m)	Weight kg/m	Code
6	168.3	12.8	6	6.50	01 512 112

Pipe - ABS Class E 217psig (15 bar)

Size	Mean OD d_1	Thickness t (mm)	Length (m)	Weight kg/m	Code
3/8	17.1	1.7	6	0.09	01 513 101
1/2	21.4	2.0	6	0.13	01 513 102
3/4	26.7	2.5	6	0.20	01 513 103
1	33.6	3.1	6	0.31	01 513 104
1 ^{1/4}	42.2	3.9	6	0.49	01 513 105
1 ^{1/2}	48.3	4.5	6	0.64	01 513 106
2	60.3	5.6	6	1.00	01 513 107
3	88.9	8.3	6	2.16	01 513 109
4	114.3	10.6	6	3.59	01 513 110

Pipe - ABS Class E 217psig (15 bar)

Size	Mean OD d_1	Thickness t (mm)	Length (m)	Weight kg/m	Code
3/8	17.1	1.7	3	0.09	01 519 101
1/2	21.4	2.0	3	0.13	01 519 102
3/4	26.7	2.5	3	0.20	01 519 103
1	33.6	3.1	3	0.31	01 519 104
1 ^{1/4}	42.2	3.9	3	0.49	01 519 105
1 ^{1/2}	48.3	4.5	3	0.64	01 519 106
2	60.3	5.6	3	1.00	01 519 107
3	88.9	8.3	3	2.16	01 519 109
4	114.3	10.6	3	3.59	01 519 110

Pipe - ABS Class T (for threading) 173 psig (12 bar after threading)

Size	Mean OD d_1	Thickness t (mm)	Length (m)	Weight kg/m	Code
3/8	17.1	3.5	6	0.16	01 514 101
1/2	21.4	3.6	6	0.22	01 514 102
3/4	26.7	3.6	6	0.28	01 514 103
1	33.6	4.3	6	0.43	01 514 104
1 ^{1/4}	42.2	5.3	6	0.65	01 514 105
1 ^{1/2}	48.3	6.0	6	0.85	01 514 106
2	60.3	7.2	6	1.28	01 514 107

Sockets Plain

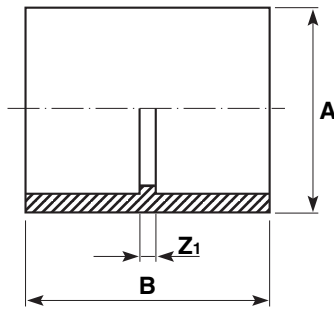

Size	PN	A	B	Z ₁	gms	Code
3/8	15	21	32	2	4	01 100 101
1/2	15	26	38	2	6	01 100 102
3/4	15	32	43	3	12	01 100 103
1	15	41	50	3	24	01 100 104
1 1/4	15	52	60	4	41	01 100 105
1 1/2	15	60	66	2	62	01 100 106
2	15	74	78	4	114	01 100 107
2 1/2	10	88	94	4	230	11 100 312
3	15	108	104	4	355	01 100 109
4	15	136	135	5	595	01 100 110
5	10	171	163	7	1390	11 100 316
6	12	201	191	9	2269	01 100 112
8	9	257	249	11	3668	01 100 113

O-Ring sockets



Size	PN	A	B	C	Z ₁	Pressure class	gms	Code
2	12	74	78	27	4	D	114	01 305 107
3	12	108	104	37	4	D	368	01 305 109
4	12	136	136	49	6	D	632	01 305 110
6	9	201	201	74	8	C	2414	01 305 112
8	6	255	255	94	14	B	3312	01 305 113

Note: O-Rings EPDM.

Not end load resistant - for buried pipework only.

Reducing bushes Plain

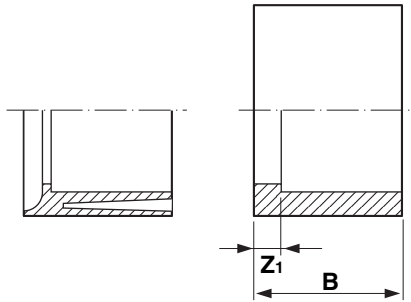
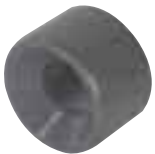

Size	PN	B	Z ₁	gms	Code
1/2 x 3/8	15	17	2	7	01 109 121
3/4 x 1/2	15	20	3	8	01 109 122
1 x 1/2	15	23	6	23	01 109 123
1 x 3/4	15	24	4	15	01 109 124
*1 1/4 x 1/2	15	28	12	21	01 109 116
*1 1/4 x 3/4	15	28	8	24	01 109 117
1 1/4 x 1	15	28	5	20	01 109 125
*1 1/2 x 1/2	15	30	13	26	01 109 118
*1 1/2 x 3/4	15	30	10	37	01 109 119
*1 1/2 x 1	15	30	7	40	01 109 126
1 1/2 x 1 1/4	15	31	4	19	01 109 127
*2 x 3/4	15	38	15	45	01 109 120
*2 x 1	15	38	15	45	01 109 128
*2 x 1 1/4	15	38	11	57	01 109 129
2 x 1 1/2	15	37	7	42	01 109 130
2 1/2 x 2	15	44	8	75	01 109 131
*3 x 1 1/2	15	51	21	130	01 109 134
*3 x 2	15	51	15	178	01 109 135
3 x 2 1/2	15	50	6	126	01 109 136
*4 x 3	15	65	12	277	01 109 141
5 x 4	15	78	15	413	01 329 142
*6 x 4	12	93	27	666	01 109 147
6 x 5	15	90	13	641	01 329 148
*8 x 6	9	110	23	1185	01 109 152

*Relief configuration (see drawing insert).

Reducing sockets Plain

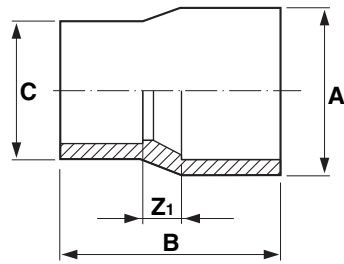

Size	PN	A	B	C	Z ₁	gms	Code
3/4 x 1/2	15	32	44	26	7	11	01 114 122
1 x 3/4	15	41	53	33	9	19	01 114 124
1 1/4 x 1	15	52	63	41	10	39	01 114 125
1 1/2 x 1 1/4	15	59	68	51	8	58	01 114 127
2 x 1 1/2	15	74	82	59	12	100	01 114 130
3 x 2	15	108	114	75	26	320	01 114 135
4 x 3	15	136	136	108	20	558	01 114 141
6 x 4	12	205	213	140	55	1975	01 114 147
8 x 6	9	256	263	198	50	3410	01 114 152

Elbows 45° Plain

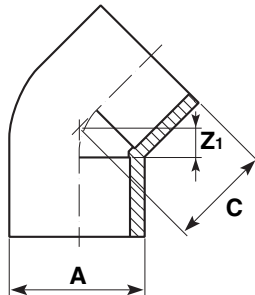

Size	PN	A	C	Z ₁	gms	Code
3/8	15	21	20	6	8	01 119 101
1/2	15	27	26	8	9	01 119 102
3/4	15	33	27	12	15	01 119 103
1	15	41	37	13	25	01 119 104
1 1/4	15	52	44	15	59	01 119 105
1 1/2	15	60	50	18	86	01 119 106
2	15	82	66	27	160	01 119 107
2 1/2	10	90	63	17	300	11 119 312
3	15	112	94	40	750	01 119 109
4	15	139	115	50	1300	01 119 110
5	10	173	115	37	1980	11 119 316
6	12	198	134	41	2390	01 119 112
8	9	259	182	65	5620	01 119 113

Elbows 90° Plain

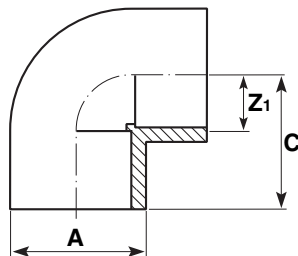

Size	PN	A	C	Z ₁	gms	Code
3/8	15	21	24	9	6	01 115 101
1/2	15	26	29	12	11	01 115 102
3/4	15	32	34	14	19	01 115 103
1	15	41	41	17	35	01 115 104
1 1/4	15	52	49	21	70	01 115 105
1 1/2	15	60	56	26	101	01 115 106
2	15	74	68	31	191	01 115 107
2 1/2	10	90	83	38	385	11 115 312
3	15	111	104	52	720	01 115 109
4	15	141	130	65	1505	01 115 110
5	10	173	153	76	2390	11 115 316
6	12	203	175	85	4075	01 115 112
8	9	256	251	112	6900	01 115 113

Tees 45° Plain

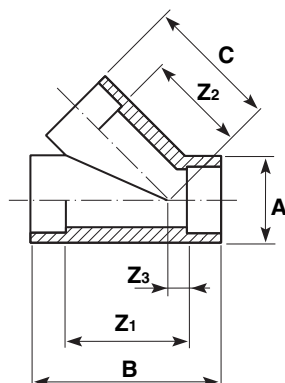

Size	PN	A	B	C	Z ₁	Z ₂	Z ₃	gms	Code
1/2	9	28	68	44	34	27	7	30	01 128 102
3/4	9	33	81	52	41	32	8	45	01 128 103
1	9	41	97	63	49	39	9	80	01 128 104
1 1/4	9	50	117	80	61	52	10	194	01 128 105
1 1/2	9	60	140	97	80	67	12	298	01 128 106
2	9	74	170	113	90	73	15	546	01 128 107

Tees 90° Equal plain

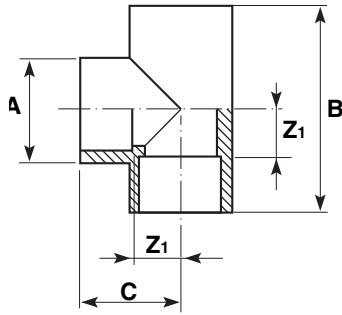

Size	PN	A	B	C	Z ₁	gms	Code
3/8	15	21	49	25	10	7	01 122 101
1/2	15	26	58	29	11	13	01 122 102
3/4	15	32	69	34	15	23	01 122 103
1	15	41	83	42	19	43	01 122 104
1 1/4	15	52	101	50	23	92	01 122 105
1 1/2	15	59	113	53	25	133	01 122 106
2	15	74	137	70	31	249	01 122 107
2 1/2	10	90	172	87	36	510	11 122 312
3	15	113	204	105	44	926	01 122 109
4	15	143	244	121	54	1960	01 122 110
5	10	172	307	153	72	3200	11 122 316
6	12	205	355	175	88	4449	01 122 112
8	9	257	468	240	100	9600	01 122 113

Tees 90° Swept plain

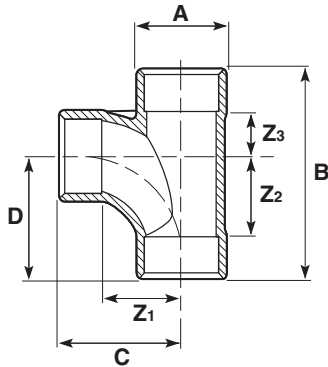

Size	PN	A	B	C	D	Z ₁	Z ₂	Z ₃	gms	Code
1	9	41	115	79	79	57	57	14	85	01 148 104
1 1/2	9	62	160	105	105	74	74	24	285	01 148 106
2	9	78	195	125	125	87	87	32	515	01 148 107
2 1/2	9	92	210	125	125	81	81	41	601	11 148 312
4	9	139	315	190	190	127	127	62	2080	01 148 110

Tees 90° Reducing

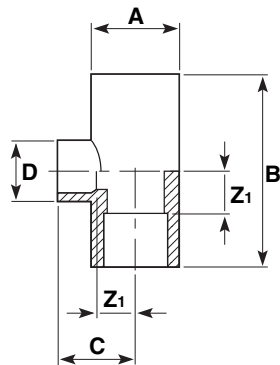

Size	PN	A	B	C	D	Z ₁	gms	Code
3/4 x 1/2	15	32	64	32	26	17	22	01 124 122
1 x 1/2	15	40	70	36	26	17	40	01 124 123
1 x 3/4	15	40	76	38	32	20	41	01 124 124

Bends 22 1/2° Long radius

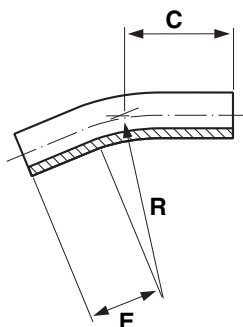

Size	PN	C	E	R	gms	Code
1	15	76	38	102	46	01 311 104
1 1/2	15	110	57	152	143	01 311 106
2	15	113	73	203	274	01 311 107
2 1/2	15	172	112	300	319	11 311 312
3	15	202	114	305	857	01 311 109
4	15	262	152	407	1886	01 311 110
5	10	322	210	560	2513	11 311 316
6	12	385	229	610	5154	01 311 112
8	9	503	305	812	8962	01 311 113

Tolerance on angle ±3°

Bends 45° Long radius

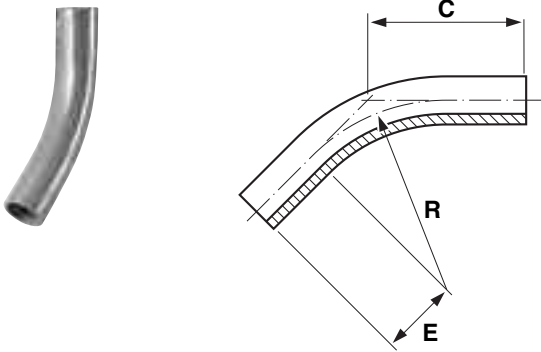

Size	PN	C	E	R	gms	Code
1	15	75	37	102	51	01 310 104
1 ^{1/2}	15	113	55	152	156	01 310 106
2	15	152	73	203	322	01 310 107
2 ^{1/2}	15	300	113	300	429	11 310 312
3	15	238	121	305	1100	01 310 109
4	15	300	145	407	2290	01 310 110
5	10	512	280	560	5315	11 310 316
6	12	440	218	610	6290	01 310 112
8	9	592	280	812	11440	01 310 113

Tolerance on angle $\pm 3^\circ$

Bends 90° Long radius

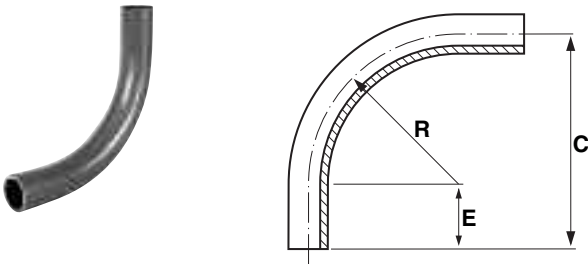

Size	PN	C	E	R	gms	Code
3	15	403	98	305	1535	01 309 109
4	15	545	138	407	3440	01 309 110
5	10	840	280	560	6696	11 309 316
6	12	817	207	610	9430	01 309 112
8	9	1174	362	812	19070	01 309 113

Tolerance on angle $\pm 3^\circ$

Bends 90° Short radius plain

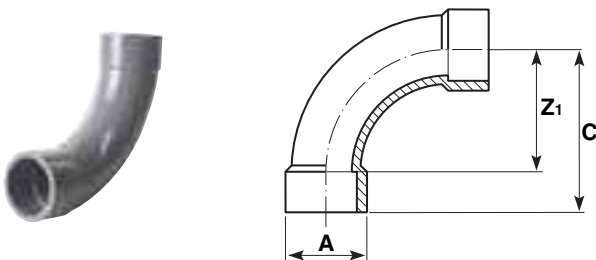

Size	PN	A	C	Z ₁	gms	Code
1/2	15	26	56	43	20	01 118 102
3/4	15	33	65	45	45	01 118 103
1	15	40	85	63	65	01 118 104
1 ^{1/4}	15	51	108	81	130	01 118 105
1 ^{1/2}	15	62	134	102	290	01 118 106
2	15	73	165	126	560	01 118 107
2 ^{1/2}	10	93	195	150	810	11 118 312
3	15	111	226	172	1445	01 118 109
4	15	140	280	216	2400	01 118 110

Saddles Plain

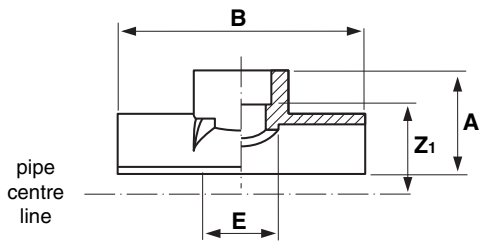

Size	PN	A	B	E	Z ₁	gms	Code
2 x 1 ¹ / ₄	15	60	136	48	33	90	01 126 129
3 x 1 ¹ / ₂	15	76	140	60	46	158	01 126 134
4 x 2	15	95	140	74	58	230	01 126 140
6 x 2	15	71	154	73	86	225	01 126 146

Two saddles can be mounted diametrically opposite.

End caps Plain

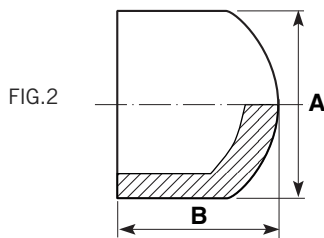
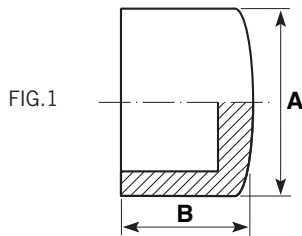

Size	PN	A	B	gms	Fig	Code
3/8	15	21	17	3	1	01 140 101
1/2	15	26	22	5	1	01 140 102
3/4	15	32	25	9	1	01 140 103
1	15	40	30	20	1	01 140 104
1 ¹ / ₄	15	52	51	33	2	01 140 105
1 ¹ / ₂	15	59	39	48	1	01 140 106
2	15	74	70	90	2	01 140 107
*2 ¹ / ₂	10	94	59	180	1	11 149 312
3	15	109	97	268	2	01 140 109
4	15	136	120	465	2	01 140 110

*2¹/₂" is rated at PN10.

Socket unions Plain

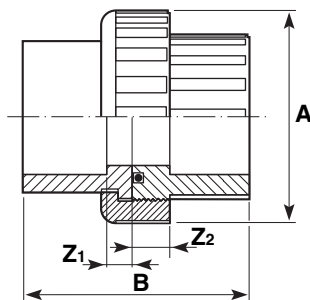

Size	PN	A	B	Z ₁	Z ₂	gms	Code
3/8	15	39	44	5	10	25	01 205 101
1/2	15	43	49	5	10	36	01 205 102
3/4	15	51	55	5	10	51	01 205 103
1	15	64	65	7	12	86	01 205 104
1 ¹ / ₄	15	72	77	10	14	122	01 205 105
1 ¹ / ₂	15	79	92	13	16	160	01 205 106
2	15	102	112	15	19	297	01 205 107
*2 ¹ / ₂	10	135	107	8	13	610	11 205 312
3	9	155	113	6	4	750	01 205 109
4	9	180	138	7	6	1155	01 205 110

EPDM seal as standard.

For FPM seal order by type 204.

*2¹/₂" is rated at PN10.

Imperial/metric socket adaptors Plain

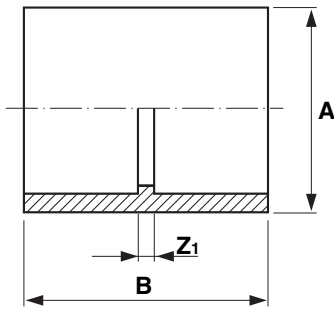

Size	PN	A	B	Z ₁	gms	Code
1/2 x 20	10	26	37	3	7	11 345 102
3/4 x 25	10	31	41	3	12	11 345 103
1 x 32	10	40	49	3	25	11 345 104
1 1/4 x 40	10	50	58	2	45	11 345 105
1 1/2 x 50	10	59	67	3	62	11 345 106
2 x 63	10	74	78	2	114	11 345 107
3 x 90	10	107	105	3	355	11 345 109
4 x 110	10	134	130	6	690	11 345 110
6 x 160	10	195	183	8	1660	11 345 112

Sockets Plain female BSP thread

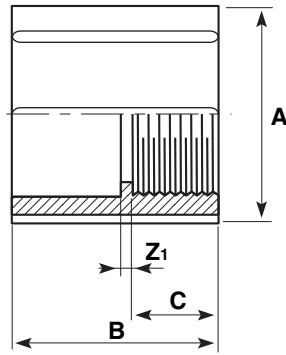

Size	PN	A	B	C	Z ₁	gms	Code
1/2	12	27	38	17	4	8	01 101 102
3/4	12	33	44	20	2	14	01 101 103
1	12	42	51	23	5	30	01 101 104
1 1/4	12	52	55	22	4	46	01 101 105
1 1/2	12	60	61	26	2	65	01 101 106
2	12	75	70	29	2	114	01 101 107
3	12	110	107	52	3	378	01 101 109

Reducing bushes Plain female BSP thread

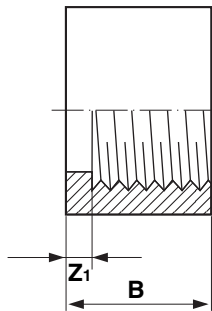

Size	PN	B	Z ₁	gms	Code
1/2 x 3/8	12	17	6	4	01 111 121
3/8 x 1/2	12	20	5	7	01 111 122
1 x 3/4	12	23	6	12	01 111 124

Elbows 90° Plain female BSP thread

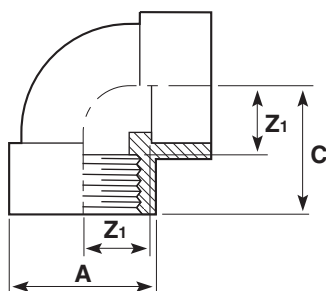

Size	PN	A	C	Z ₁	gms	Code
1/2	12	26	34	17	26	01 116 102
3/4	12	32	36	20	34	01 116 103
1	12	40	41	23	63	01 116 104
1 1/2	12	62	57	30	136	01 116 106
2	12	75	66	35	203	01 116 107

Female threaded adaptors Plain spigot end/female BSP thread

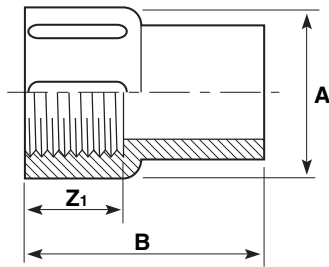

Size	PN	A	B	Z ₁	gms	Code
1/2	12	27	38	16	8	01 153 102
3/4	12	36	44	18	14	01 153 103
1	12	43	50	21	24	01 153 104
1 1/4	12	55	60	22	49	01 153 105
1 1/2	12	63	66	25	68	01 153 106
2	12	78	78	29	129	01 153 107

Hexagon nipples Plain spigot/male BSP thread

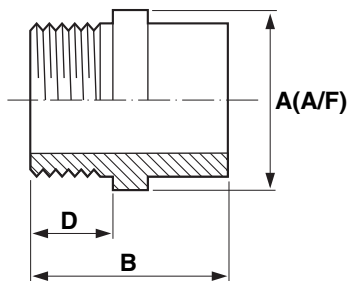

Size	PN	A	B	D	gms	Code
3/8	12	24	36	11	7	01 107 101
1/2	12	30	42	15	12	01 107 102
3/4	12	36	48	16	30	01 107 103
1	12	46	56	20	40	01 107 104
1 1/4	12	46	60	21	50	01 107 105
1 1/2	12	55	63	22	58	01 107 106
2	12	72	74	26	91	01 107 107

Male threaded fittings Plain/brass male thread



Size	D	D ₁	l	z	SW	Code
1/2 x 1/2	35	29	55	40	36	01 228 102
3/4 x 3/4	43	34	58	42	44	01 228 103
1 x 1	50	43	66	48	51	01 228 104
1 1/4 x 1 1/4	62	52	74	53	63	01 228 105

ALL Durapipe Brass Components are manufactured using DZR Brass.

Female threaded fittings Plain/brass female thread

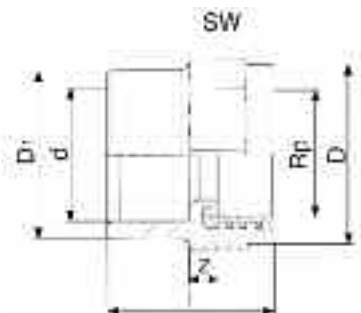

Size	D	D ₁	l	z	SW	Code
1/2 x 1/2	35	29	40	11	36	01 229 102
3/4 x 3/4	43	34	42	11	44	01 229 103
1 x 1	50	43	48	12	51	01 229 104
1 1/4 x 1 1/4	62	55	54	13	63	01 229 105

ALL Durapipe Brass Components are manufactured using DZR Brass.

Male threaded adaptors Plain/male BSP taper threaded

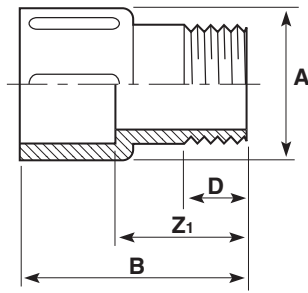

Size	PN	A	B	D	Z ₁	gms	Code
3/8	12	22	35	10	20	5	01 151 101
1/2	12	27	45	12	28	9	01 151 102
3/4	12	35	48	14	28	14	01 151 103

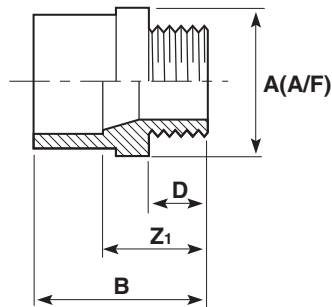

Size	PN	A	B	D	Z ₁	gms	Code
1	12	46	58	19	35	36	01 151 104
1 1/4	12	56	66	22	38	70	01 151 105
1 1/2	12	72	75	22	43	115	01 151 106
2	12	80	85	26	46	150	01 151 107

Barrel nipples Plain/BSP taper threaded

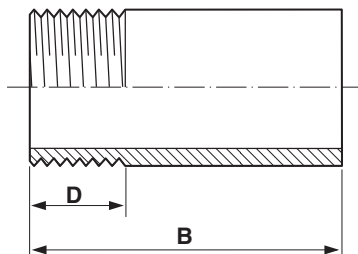

Size	PN	B	D	gms	Code
3	12	128	30	252	01 316 109
4	12	153	36	525	01 316 110

Hose adaptors BSP taper threaded/hose tail

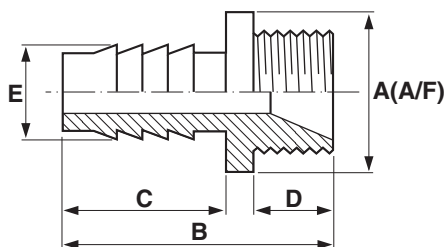

Size	PN	A	B	C	D	E	gms	Code
1/2	12	26	60	41	13	14	8	01 157 102
3/4	12	28	66	41	16	20	15	01 157 103
1	12	40	73	46	19	27	28	01 157 104

Tank connectors Plain spigot/male BSP parallel thread

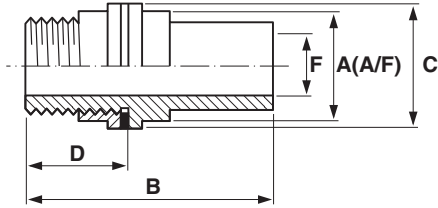

Size	A	B	C	D	F	gms	Code
1/2	28	70	38	28	15	26	01 235 102
3/4	33	77	38	38	21	30	01 235 103

Composite unions Plain/brass, female BSP parallel thread

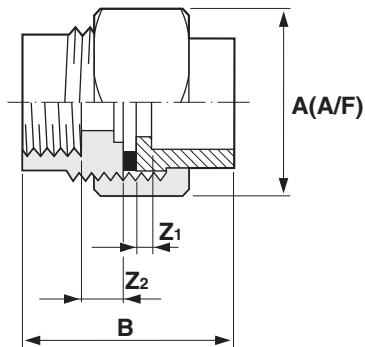

Size	PN	A	B	Z ₁	Z ₂	gms	Code
1/2	15	40	42	3	7	165	01 212 102
3/4	15	48	49	3	9	290	01 212 103
1	15	55	59	11	12	310	01 212 104
1 1/4	15	65	68	9	10	450	01 212 105
1 1/2	15	79	75	12	14	800	01 212 106
2	15	88	90	14	14	950	01 212 107

Fitted with brass retaining nut.

Brass material to BS2872, WRAS approved.

ALL Durapipe Brass Components are manufactured using DZR Brass.

Composite unions Plain/brass, male BSP taper thread

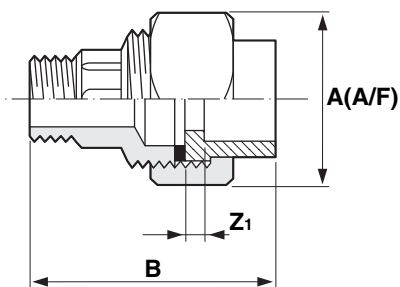

Size	PN	A	B	Z ₁	gms	Code
1/2	15	40	54	3	175	01 217 102
3/4	15	48	74	3	320	01 217 103
1	15	55	86	8	420	01 217 104
1 1/4	15	65	94	10	620	01 217 105
1 1/2	15	78	108	13	1000	01 217 106
2	15	88	129	15	1200	01 217 107

Fitted with brass retaining nut.

Brass material to BS2872, WRAS approved.

ALL Durapipe Brass Components are manufactured using DZR Brass.

Sockets Female BSP taper thread

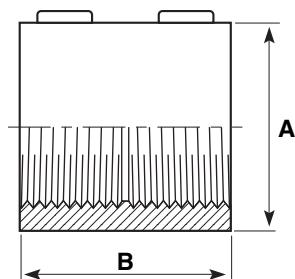

Size	PN	A	B	gms	Code
1/2	12	26	38	12	01 102 102
3/4	12	33	43	22	01 102 103
1	12	41	51	34	01 102 104
1 1/4	12	51	54	60	01 102 105
1 1/2	12	62	63	87	01 102 106
2	12	75	72	132	01 102 107
3	12	110	107	437	01 102 109

Reducing bushes Male/female BSP thread

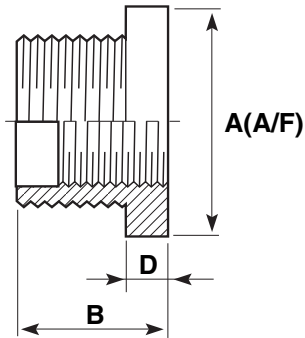

Size	PN	A	B	D	gms	Code
1/2 x 3/8	12	24	25	10	5	01 113 121
3/4 x 1/2	12	30	27	11	10	01 113 122
1 x 3/4	12	36	31	12	13	01 113 124

Male thread taper.
Female thread parallel.

Elbows 90° Female BSP taper thread

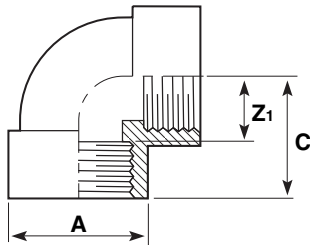

Size	PN	A	C	Z ₁	gms	Code
1/2	12	26	29	17	27	01 117 102
3/4	12	32	33	19	39	01 117 103
1	12	41	41	23	65	01 117 104
1 1/2	12	63	57	30	141	01 117 106
2	12	75	67	35	212	01 117 107

End caps Female BSP taper thread

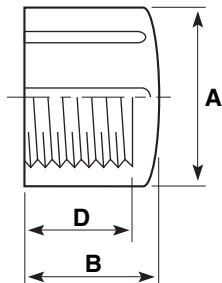

Size	PN	A	B	D	gms	Code
3/8	12	26	20	16	5	01 141 101
1/2	12	27	20	16	6	01 141 102
3/4	12	36	23	17	10	01 141 103
1	12	44	28	21	18	01 141 104
1 1/4	12	55	31	22	33	01 141 105
1 1/2	12	63	35	25	50	01 141 106
2	12	78	40	28	90	01 141 107
3	12	111	65	53	262	01 141 109

Plugs Male BSP taper thread

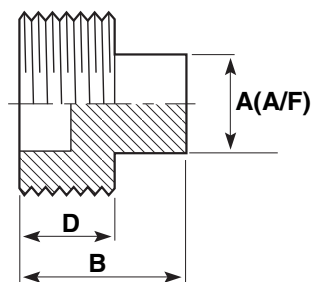

Size	PN	A	B	D	gms	Code
3/8	12	11	19	10	3	01 155 101
1/2	12	13	23	14	5	01 155 102
3/4	12	14	28	15	8	01 155 103
1	12	17	30	17	12	01 155 104
1 1/4	12	22	35	22	30	01 155 105
1 1/2	12	27	38	22	36	01 155 106
2	12	37	45	26	50	01 155 107

Hexagon nipples Male BSP taper thread

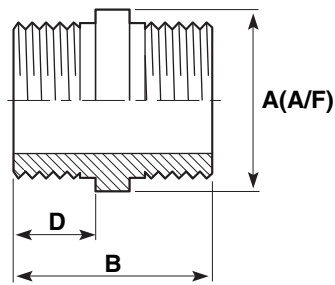

Size	PN	A	B	D	gms	Code
3/8	12	24	38	14	6	01 106 101
1/2	12	30	46	18	12	01 106 102
3/4	12	36	50	19	30	01 106 103
1	12	46	59	13	40	01 106 104
1 1/4	12	46	67	27	55	01 106 105
1 1/2	12	55	73	29	75	01 106 106
2	12	72	81	33	125	01 106 107

Back nuts Female BSP taper thread

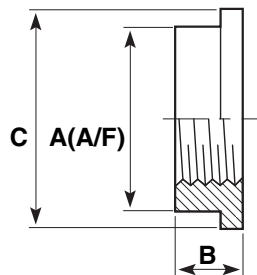

Size	PN	A	B	C	gms	Code
3/8	12	25	11	29	5	01 159 101
1/2	12	28	13	38	8	01 159 102
3/4	12	33	13	38	15	01 159 103
1	12	45	16	54	18	01 159 104
1 1/4	12	50	18	58	19	01 159 105
1 1/2	12	60	19	69	31	01 159 106
2	12	79	21	91	65	01 159 107

Flanges stub Plain/serrated

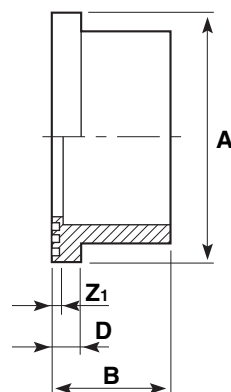

Size	PN	A	B	D	Z ₁	gms	Code
2	15	96	40	14	3	90	01 135 107
2 1/2	10	106	49	10	4	150	11 135 312
3	15	127	57	18	6	200	01 135 109
4	15	159	69	20	6	350	01 135 110
5	15	180	83	14	7	680	11 135 316
6	12	213	104	24	11	805	01 135 112
8	9	269	132	26	14	2075	01 135 113

All Durapipe flanges are designed for use with Durapipe backing rings. Guarantees are null and void if used with incorrect backing ring.

Flanges full face Plain/drilled

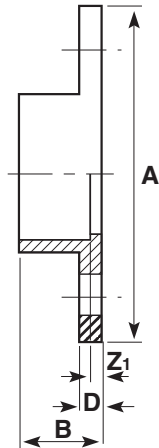

BS10 Table D/E

Size	A	B	D	Z ₁	P.C.D.	No. of Holes	Hole Diameter	gms	Code
1/2	96	21	10	4	67	4	14	68	01 130 102
3/4	105	24	10	4	73	4	14	78	01 130 103
1	115	27	10	4	83	4	14	107	01 130 104
1 1/4	140	33	10	5	87	4	14	122	01 130 105
1 1/2	150	37	10	5	98	4	14	154	01 130 106
2	166	45	10	6	115	4	18	223	01 130 107
3	199	60	11	8	145	4	18	398	01 130 109
*4	220	72	14	6	178	8	18	638	01 130 110
6	284	98	22	8	235	8	22	1340	01 130 112

*4" BS10 Table D has 4 holes and should be ordered as 01 317 110.

BS4504 Table 16/3-10/3

Size	A	B	D	Z ₁	P.C.D.	No. of Holes	Hole Diameter	gms	Code
1/2	96	21	10	4	65	4	14	68	01 319 102
3/4	105	24	10	4	75	4	14	78	01 319 103
1	115	27	10	4	85	4	14	107	01 319 104
1 1/4	140	33	10	5	100	4	18	122	01 319 105
1 1/2	150	37	10	5	110	4	18	154	01 319 106
2	166	45	10	6	125	4	18	223	01 319 107
3	199	60	11	8	160	8	18	398	01 319 109
4	220	72	14	6	180	8	18	638	01 319 110
6	284	98	22	8	240	8	22	1340	01 319 112

ANSI Class 150

Size	A	B	D	Z ₁	P.C.D.	No. of Holes	Hole Diameter	gms	Code
1/2	96	21	10	4	60	4	14	68	01 322 102
3/4	105	24	10	4	70	4	14	78	01 322 103
1	115	27	10	4	80	4	14	107	01 322 104
1 1/2	150	37	10	5	98	4	14	154	01 322 106
2	166	45	10	6	121	4	18	223	01 322 107
3	199	60	11	8	152	4	18	398	01 322 109
4	220	72	14	6	190	8	18	638	01 322 110
6	284	98	22	8	241	8	22	1340	01 322 112

Undrilled

Size	PN	A	B	D	Z ₁	gms	Code
1/2	15	96	21	10	4	75	01 129 102
3/4	15	105	24	10	4	85	01 129 103
1	15	115	27	10	4	111	01 129 104
1 1/4	15	140	32	10	4	130	01 129 105
1 1/2	15	150	36	10	5	160	01 129 106
2	15	165	45	11	6	233	01 129 107
3	15	199	60	11	8	414	01 129 109
4	15	220	73	14	6	657	01 129 110
6	12	284	99	22	8	1417	01 129 112

Note: Durapipe backing rings must be used in conjunction with full face flanges.

All Durapipe flanges are designed for use with Durapipe backing rings. Guarantees are null and void if used with incorrect backing ring.

Flanges blanking Plain/drilled

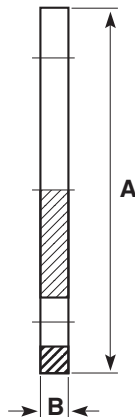

BS10 Table D/E

Size	A	B	P.C.D.	No. of Holes	Hole Diameter	gms	Code
2	165	13	115	4	18	235	01 313 107
3	197	19	145	4	18	520	01 313 109
*4	214	19	178	8	18	720	01 313 110
6	286	26	235	8	22	1575	01 313 112
8	337	26	292	8	22	2300	01 313 113

*4" BS10 Table D has 4 holes and should be ordered as 01 326 110.

BS4504 Table 16/3 (1/2" to 8") 10/3 (1/2" to 6")

Size	A	B	P.C.D.	No. of Holes	Hole Diameter	gms	Code
2	165	13	125	4	18	235	01 323 107
2 1/2	186	19	145	4	18	568	11 323 312
3	197	19	160	8	18	520	01 323 109
4	214	19	180	8	18	720	01 323 110
5	251	26	210	8	18	1338	11 323 316
6	286	26	240	8	22	1575	01 323 112
8	337	26	295	12	22	2300	01 323 113

ANSI Class 150

Size	A	B	P.C.D.	No. of Holes	Hole Diameter	gms	Code
2	165	13	121	4	18	235	01 325 107
3	197	19	152	4	18	520	01 325 109
4	214	19	190	8	18	720	01 325 110
6	286	26	241	8	22	1575	01 325 112
8	337	26	298	8	22	2300	01 325 113

Undrilled

Size	PN	A	B	gms	Code
1	15	116	13	140	01 131 104
1 1/2	15	150	13	185	01 131 106
2	15	166	13	235	01 131 107
3	15	197	19	520	01 131 109
4	15	214	19	720	01 131 110
6	12	286	26	1575	01 131 112
8	9	337	26	2300	01 131 113

Note: Durapipe backing rings must be used in conjunction with blank flanges.

**DURAPIPE UK MANUFACTURE FULLY MATCHED PIPEWORK SYSTEMS.
AS A RESULT WE DO NOT RECOMMEND THE USE OF NON-DURAPIPE PRODUCTS
INCLUDING BACKING RINGS, GASKETS, SOLVENT CEMENT AND CLEANER.**

INSIST ON DURAPIPE.

All Durapipe flanges are designed for use with Durapipe backing rings. Guarantees are null and void if used with incorrect backing ring.

Backing rings Galvanised mild steel drilled

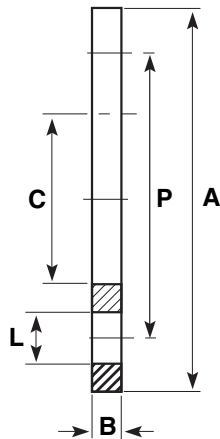

BS10 Table D/E

Size	A	B	C	P	No. of Holes	Hole Dia.	Bolt Size	Weight gms	Code
1/2	95	6	35	67	4	14	M12x50	270	03 416 102
3/4	103	7	45	73	4	14	M12x50	300	03 416 103
1	114	6	49	83	4	14	M12x50	380	03 416 104
1 1/4	120	7	60	87	4	14	M12x50	380	03 416 105
1 1/2	135	7	68	98	4	14	M12x50	480	03 416 106
2	151	8	78	115	4	18	M16x65	880	03 416 107
3	187	9	110	145	4	18	M16x70	1040	03 416 109
*4	216	9	140	178	8	18	M16x80	1330	03 416 110
6	282	11	195	235	8	22	M20x90	2340	03 416 112
8	337	10	255	292	8	22	M20x100	2870	03 416 113

*4" BS10 Table D has 4 holes and should be ordered as 03 415 110.

BS4504 Table 16/3 (1/2" to 12") 10/3 (1/2" to 6")

Size	A	B	C	P	No. of Holes	Hole Dia.	Bolt Size	Weight gms	Code
1/2	95	6	35	65	4	14	M12x50	310	03 421 102
3/4	106	6	45	75	4	14	M12x50	330	03 421 103
1	114	6	49	85	4	14	M12x50	390	03 421 104
1 1/4	141	6	60	100	4	18	M16x50	580	03 421 105
1 1/2	150	6	68	110	4	18	M16x50	880	03 421 106
2	165	8	78	125	4	18	M16x65	1020	03 421 107
2 1/2	186	9	92	145	4	18	M16x65	1280	13 421 312
3	200	8	110	160	8	18	M16x70	1310	03 421 109
4	221	8	140	180	8	18	M16x80	1370	03 421 110
5	251	11	167	210	8	18	M16x90	2060	13 421 316
6	286	11	195	240	8	22	M20x90	2460	03 421 112
8	339	11	255	295	12	22	M20x100	2780	03 421 113

BS4504 Table 10/3 (8")

Size	A	B	C	P	No. of Holes	Hole Dia.	Bolt Size	Weight gms	Code
8	339	11	255	295	8	22	M20x100	2870	03 404 113

Note: The 8" backing ring drilled 10/3 is intended for use in conjunction with the 8" FK Butterfly valve, as the PN10 drilling has 8 holes as apposed to the 12 holes on the PN16 drilling.

ANSI Class 150

Size	A	B	C	P	No. of Holes	Hole Dia.	Bolt Size	Weight gms	Code
1/2	89	6	35	60	4	14	M12x50	240	03 425 102
3/4	98	6	45	70	4	14	M12x50	270	03 425 103
1	108	6	49	80	4	14	M12x50	330	03 425 104
1 1/2	128	6	68	98	4	14	M12x50	420	03 425 106
2	153	8	78	121	4	18	M16x65	790	03 425 107
3	191	8	110	152	4	18	M16x65	1200	03 425 109
4	230	9	140	190	8	18	M16x70	1580	03 425 110
6	280	11	195	241	8	22	M20x90	2230	03 425 112
8	340	12	255	298	8	22	M20x100	3060	03 425 113

*Bolt lengths shown are for flange/flange assemblies only.

Gaskets flat Stub flange EPDM

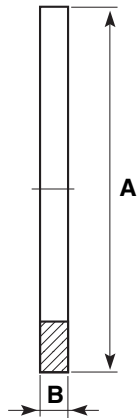

Size	A	B	gms	Code
2	97	3.0	21	03 431 107
2 ^{1/2}	106	3.0	22	13 411 312
3	128	3.0	23	03 431 109
4	160	3.9	36	03 431 110
5	180	4.0	60	13 411 316
6	214	3.9	74	03 431 112
8	269	4.0	92	03 431 113

Gaskets full face Drilled EPDM

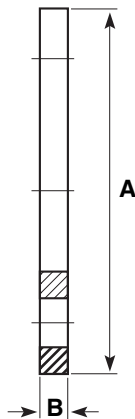

BS10 Table D/E

Size	A	B	P.C.D.	No. of Holes	Hole Diameter	gms	Code
1/2	95	3.0	67	4	14	31	03 410 102
3/4	112	3.0	73	4	14	37	03 410 103
1	115	3.0	83	4	14	37	03 410 104
1 ^{1/4}	121	3.0	87	4	14	41	03 410 105
1 ^{1/2}	133	3.0	98	4	14	55	03 410 106
2	153	3.0	115	4	18	56	03 410 107
3	184	3.0	145	4	18	98	03 410 109
*4	216	3.2	178	8	18	112	03 410 110
6	250	3.1	235	8	22	160	03 410 112

*4" BS10 Table D has 4 holes and should be ordered as 03 409 110.

BS4504 Table 16/3-10/3

Size	A	B	P.C.D.	No. of Holes	Hole Diameter	gms	Code
1/2	95	3.0	65	4	14	31	03 408 102
3/4	112	3.0	75	4	14	37	03 408 103
1	115	3.0	85	4	14	37	03 408 104
1 ^{1/4}	121	3.0	100	4	18	41	03 408 105
1 ^{1/2}	133	3.0	110	4	18	55	03 408 106
2	153	3.0	125	4	18	56	03 408 107
3	184	3.0	160	8	18	98	03 408 109
4	216	3.2	180	8	18	112	03 408 110
6	280	3.1	240	8	22	160	03 408 112

ANSI Class 150

Size	A	B	P.C.D.	No. of Holes	Hole Diameter	gms	Code
1/2	95	3.0	60	4	14	31	03 426 102
3/4	112	3.0	70	4	14	37	03 426 103
1	115	3.0	80	4	14	37	03 426 104
1 ^{1/2}	133	3.0	98	4	14	55	03 426 106
2	153	3.0	121	4	18	56	03 426 107
3	184	3.0	152	4	18	98	03 426 109
4	216	3.2	190	8	18	112	03 426 110
6	280	3.1	241	8	22	160	03 426 112

Valve support plates Galvanised mild steel

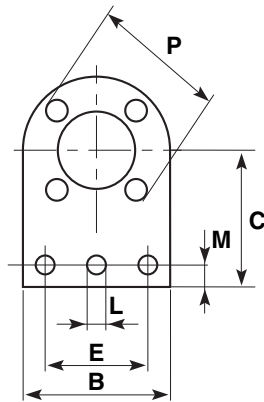

BS4504 Table 16/3 (1/2" to 8") **10/3** (1/2" to 6")

Size	B	C	E	L	M	N	P	Weight gms	Code
1/2	95	86	50	14	16	2	65	370	03 458 102
3/4	106	89	75	14	16	2	75	450	03 458 103
1	143	99	75	14	16	2	85	560	03 458 104
1 1/4	152	105	75	14	16	2	100	950	03 458 105
1 1/2	151	105	74	14	16	2	110	1150	03 458 106
2	166	127	101	14	17	2	125	1380	03 458 107
2 1/2	185	144	125	14	22	2	145	2500	31 459 312
3	201	143	127	14	22	2	160	1650	03 458 109
4	222	161	151	14	24	3	180	2550	03 458 110
6	286	217	228	14	33	3	240	4100	03 458 112
8	340	242	280	14	31	3	295	6250	03 458 113

N = No. of holes in base.

O-Ring for socket unions For use with socket unions

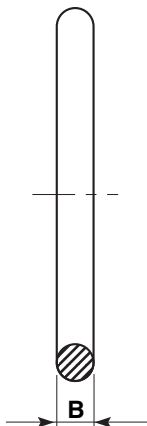

Size	B	gms	EPDM Code	FPM Code
3/8	3.5	0.5	03 209 101	03 211 101
1/2	3.5	1	03 209 102	03 211 102
3/4	3.5	2	03 209 103	03 211 103
1	3.5	3	03 209 104	03 211 104
1 1/4	5.2	5	03 209 105	03 211 105
1 1/2	5.2	6	03 209 106	03 211 106
2	5.3	7	03 209 107	03 211 107

Valves

VKD Double union ball valves Manual – EPDM seals

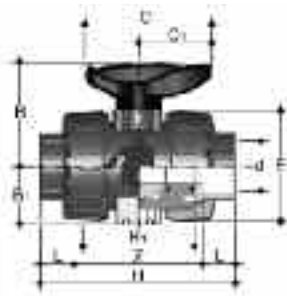

d	DN	PN	L	Z	H	E	B	C	gms	Code
3/8	10	16	14.5	74	103	55	49	66	195	HO DKA 101
1/2	15	16	16.5	70	103	55	49	66	195	HO DKA 102
3/4	20	16	19	77	115	66	59	75	315	HO DKA 103
1	25	16	22.5	83	128	75	66	85	435	HO DKA 104
1 1/4	32	16	26	94	146	87	75	97	655	HO DKA 105
1 1/2	40	16	30	104	164	100	87	110	880	HO DKA 106
2	50	16	36	127	199	122	101	134	1560	HO DKA 107

Options:

FPM seals (plain ends) order HO DKB***

FPM seals (threaded ends) order HO DKB***

Manual valves can be supplied with locking kits - further information is available from our Valve Department.

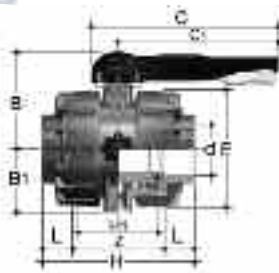

d	DN	PN	Z	L	H	H ₁	E	B	B ₁	C	C ₁	gms	Code
2 1/2	65	16	147	44	235	133	164	164	87	225	175	4380	HO DKA 108
3	80	16	168	51	270	149	203	177	105	327	272	7200	HO DKA 109
4	100	16	186	61	308	167	238	195	129	385	330	11141	HO DKA 110

Options:

FPM seals (plain ends) order HO DKB***

TKD 3-way ball valves Manual – EPDM seals

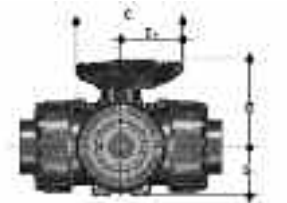

T port design

d	DN	PN	H	Z	C	C ₁	B	B ₁	gms	Code
1/2	15	16	125	95	67	40	54	29	310	HO TTA 102
3/4	20	16	146	114	85	49	65	34.5	550	HO TTA 103
1	25	16	166	129	85	49	65.9	39	790	HO TTA 104
1 1/4	32	16	195.5	151	108	64	82.5	46	1275	HO TTA 105
1 1/2	40	16	211	166	108	64	89	52	1660	HO TTA 106
2	50	16	253.5	199	134	76	108	62	2800	HO TTA 107

Options:

FPM seals (plain ends) order HO TTB***

FPM seals (threaded ends) order HO TTB***

Manual valves can be supplied with locking kits - further information is available from our Valve Department.

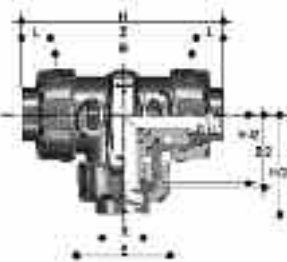

L port design

d	DN	PN	H	Z	C	C ₁	B	B ₁	gms	Code
1/2	15	16	125	95	67	40	54	29	310	HO LTA 102
3/4	20	16	146	114	85	49	65	34.5	550	HO LTA 103
1	25	16	166	129	85	49	65.9	39	790	HO LTA 104
1 1/4	32	16	195.5	151	108	64	82.5	46	1275	HO LTA 105
2	50	16	253.5	199	134	76	108	62	2800	HO LTA 107

Options:

FPM seals (plain ends) order HO LTB***

VKD & TKD ball valves can be supplied electrically or pneumatically actuated.

EV Double union ball valves Manual – EPDM seals

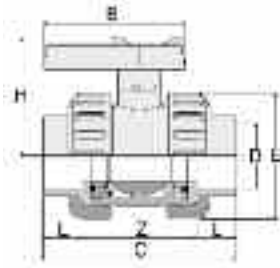

d	DN	PN	L	Z	C	E	H	B	gms	Code	
										Plain	Threaded
1/2	15	10	17	47	81	50	50	57	95	HO EVA 102	HO EVA B02
3/4	20	10	19	51	95	59	55	66	156	HO EVA 103	HO EVA B03
1	25	10	22	61	105	68	66.5	75	228	HO EVA 104	HO EVA B04
1 1/4	32	10	31	84	146	96	93	103	540	HO EVA 105	HO EVA B05
1 1/2	40	10	31	84	146	96	93	103	540	HO EVA 106	HO EVA B06
2	50	10	38	96	172	116	107	121	844	HO EVA 107	HO EVA B07

UC Ball check valves Plain ends – EPDM seals (other options available)

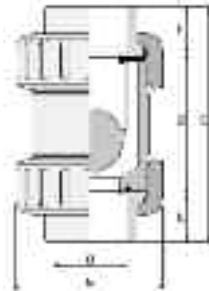

Size	L	Z	C	E	gms	Code
1/2	17	48	82	50	96	HO UCA 102
3/4	19	55	93	59	99	HO UCA 103
1	22	62	106	68	145	HO UCA 104
1 1/4	26	75	127	80	234	HO UCA 105
1 1/2	31	84	146	96	357	HO UCA 106
2	38	99	175	116	937	HO UCA 107

Options:

EPDM seals (threaded ends) order HO UCA B**

FPM seals (plain ends) order HO UCB***

FPM seals (threaded ends) order HO UCB B**

Note: this valve must be installed at a minimum distance of 10 x nominal diameter (eg. 20" for size 2") from pump flange.

UA Air release valves Plain ends – EPDM seals (other options available)

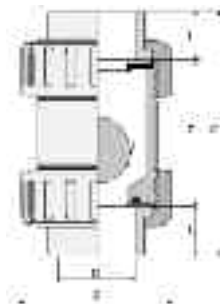

Size	L	Z	C	E	gms	Code
1/2	17	48	82	50	96	HO UAA 102
3/4	19	55	93	59	99	HO UAA 103
1	22	62	106	68	145	HO UAA 104
1 1/4	26	75	127	80	234	HO UAA 105
1 1/2	31	84	146	96	357	HO UAA 106
2	38	99	175	116	937	HO UAA 107

Options:

EPDM seals (threaded ends) order HO UAA B**

FPM seals (plain ends) order HO UAB***

FPM seals (threaded ends) order HO UAB B**

RV Y-Type strainers Plain ends – EPDM seals

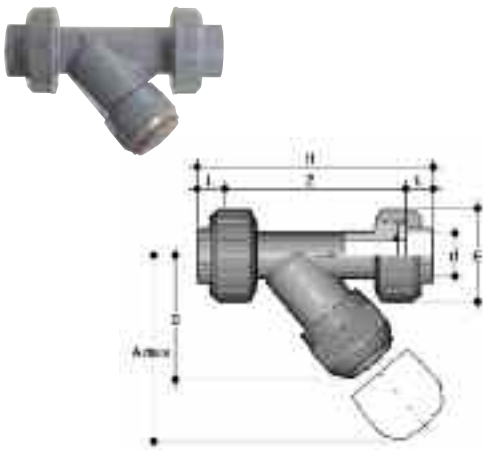

d	DN	PN	A	B	E	L	Z	H	Fig.	gms	Code
			Grey		max						
1/2	15	15	125	72	55	16	103	135	A	162	HO UVA 102
3/4	20	15	145	84	66	19	120	158	A	274	HO UVA 103
1	25	15	165	95	75	22	132	176	A	403	HO UVA 104
1 1/4	32	15	190	111	87	26	155	207	A	562	HO UVA 105
1 1/2	40	15	210	120	100	31	181	243	A	839	HO UVA 106
2	50	9	240	139	120	38	222	298	A	1413	HO UVA 107

Options:

EPDM seals (threaded ends) order HO RVA B**

FPM seals (plain ends) order HO RVB***

FPM seals (threaded ends) order HO RVB B**

VM Diaphragm valves Manual – plain union ends – EPDM seals

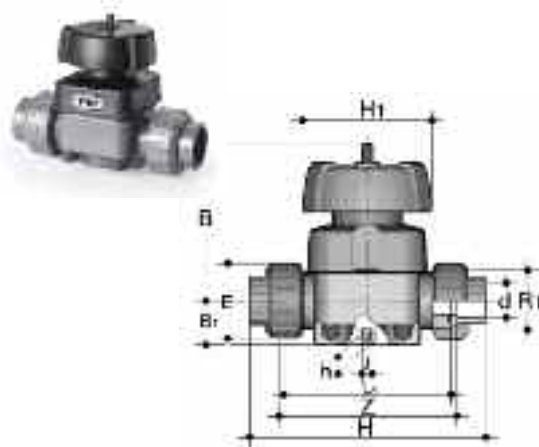

d	DN	PN	B	B ₁	H	h	H ₁	J	L	gms	Code
1/2	15	10	95	26	124	12	90	M6	16	700	HO UMA 102
3/4	20	10	95	26	144	12	90	M6	19	700	HO UMA 103
1	25	10	95	26	154	12	90	M6	23	700	HO UMA 104
1 1/4	32	10	126	40	174	18	115	M8	27	1500	HO UMA 105
1 1/2	40	10	126	40	194	18	115	M8	32	1500	HO UMA 106
2	50	10	148	40	224	18	140	M8	39	2400	HO UMA 107
* 2 1/2	65	10	225	55	284	23	215	M12	44	7000	HO VMA 208
* 3	80	10	225	55	300	23	215	M12	51	7000	HO VMA 209
* 4	100	10	295	69	350	23	250	M12	-	10500	HO VMA 210

Options:

FPM diaphragm order HO VMB***

PTFE diaphragm order HO VMC***

Manual valves can be supplied with locking kits - further information is available from our Valve Department.

*Note: 2 1/2", 3" and 4" are spigot ended.

PR Pressure relief valves EPDM seals

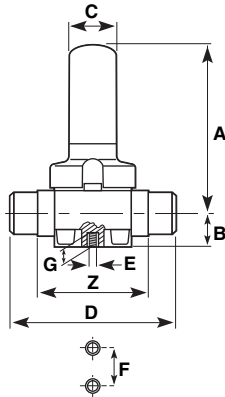

Size	PN	Z	A	B	C	D	E	F	G	gms	Code
1/2	10	92	143	20.5	35	124	M6	25	12	700	HO PRA 202
3/4	10	106	143	20.5	35	144	M6	25	12	700	HO PRA 203
1	10	108	143	25.0	35	154	M6	25	12	700	HO PRA 204
1 1/4	10	120	204	36.0	50	174	M8	44.5	16	1500	HO PRA 205
1 1/2	10	130	204	39.5	50	194	M8	44.5	16	1500	HO PRA 206
2	10	146	219	49.0	50	224	M8	44.5	16	2400	HO PRA 207

Options:
FPM seals order HO PRB***

FK Butterfly valves Glass reinforced polypropylene with ABS disc and EPDM seals

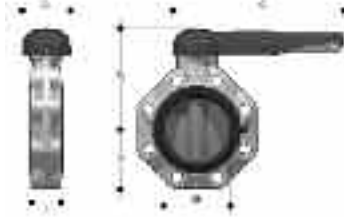

lever operated

Size	DN	PN	B ₂	B ₃	C	C ₁	Z	gms	U	Code
1 1/2	40	16	60	137	175	100	33	900	4	HO FKA 106
2	50	16	70	143	175	100	43	1080	4	HO FKA 107
2 1/2	65	10	80	164	272	110	46	1470	4	HO FKA 108
3	80	10	93	178	272	110	49	1870	8	HO FKA 109
4	100	10	107	192	272	110	56	2220	8	HO FKA 110
5	125	10	120	212	330	110	64	3100	8	HO FKA 111
6	150	10	134	225	330	110	70	3850	8	HO FKA 112
8	200	10	161	272	420	122	71	6750	8	HO FKA 113

Options:
FPM seals order HO FKB***

U = No. of holes

with gear box

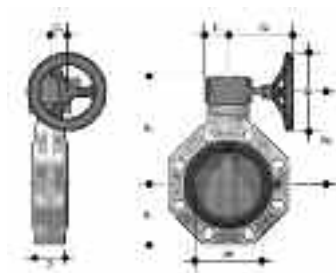

Size	DN	PN	B ₂	B ₅	B ₆	G	G ₁	G ₂	G ₃	Z	gms	U	Code
2 1/2	65	10	80	174	146	48	135	39	125	46	2400	4	HV FKA 108
3	80	10	93	188	160	48	135	39	125	49	2800	8	HV FKA 109
4	100	10	107	202	174	48	135	39	125	56	3150	8	HV FKA 110
5	125	10	120	222	194	48	144	39	200	64	4450	8	HV FKA 111
6	150	10	134	235	207	48	144	39	200	70	5200	8	HV FKA 112
8	200	10	161	287	256	65	204	60	200	71	9300	8	HV FKA 113
10	250	10	210	317	281	88	236	76	250	114	18600	12	HV FKA 114
12	300	8	245	374	338	88	236	76	250	114	25600	12	HV FKA 115

Options:
FPM seals order HV FKB***

U = No. of holes

Note: Lugged versions available to special order. Please refer to our Valve Department for further details.

Valves can be supplied as electrically or pneumatically actuated. For further details contact our Valve department on 01543 272424.

Accessories

One-step solvent cement



Litres	gms	Code
0.5	550	03 461 395
1.0	1100	03 461 396

Only Durapipe ABS solvent cement and Durapipe Eco-cleaner should be used for jointing of Durapipe ABS pipework systems.

Eco-cleaner



Litres	gms	Code
0.5	500	03 457 395

Only Durapipe ABS solvent cement and Durapipe Eco-cleaner should be used for jointing of Durapipe ABS pipework systems.

Cobra pipe clips Polypropylene

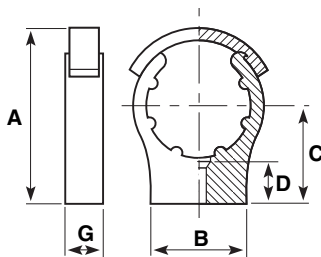

Size	A	B	C	D	G	Bolt/Screw size	gms	Code
3/8	-	35	25	19	16	M.4/3BA/No 8	7	13 434 305
1/2	-	35	30	14	16	M.5/1BA/No 10	8	13 434 306
3/4	-	35	35	16	17	M.5/1BA/No 10	11	13 434 307
1	-	40	40	17	17	M.5/1BA/No 10	14	13 434 308
1 1/4	75	45	45	20	20	M.5/1BA/No 10	21	13 434 309
1 1/2	85	50	50	22	21	M.6/0BA/No 10	30	13 434 310
2	102	60	60	19	21	M.6/0BA/No 10	42	13 434 311
2 1/2	122	70	70	27	31	M.8	94	13 434 312
3	148	80	90	39	31	M.8	121	13 434 313
4	171	90	96	36	35	M.8	185	13 434 314
5	211	156	132	40	40	M.8	252	13 434 316
6	243	170	150	40	40	M.8	330	13 434 317

Clips of size 1 1/4" and above are fitted with retaining strap.
Bolts/screws not supplied.

Saddle clips Polypropylene

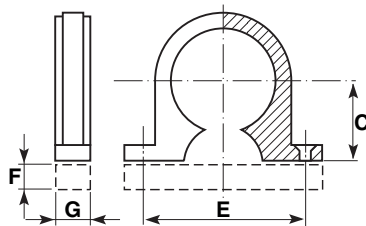

Size	C	E	F	G	Bolt/Screw size	gms	Code
3/8	13	37	-	14	M.4/3BA/No 8	3	03 455 101
1/2	18	41	-	14	M.4/3BA/No 8	4	03 455 102
3/4	21	45	-	16	M.5/2BA/No 10	6	03 455 103
1	23	56	-	16	M.5/2BA/No 10	7	03 455 104
1 1/4	29	65	-	16	M.5/2BA/No 10	11	03 455 105
1 1/2	34	67	-	16	M.5/2BA/No 10	12	03 455 106
2	38	87	-	22	M.6/0BA/No 12	25	03 455 107
3	50	122	8	34	M.10/3/8UNC	45	03 455 109
4	65	156	13	38	M.10/3/8UNC	70	03 455 110

Backing plate shown dotted supplied with 3" and 4" only.
Bolts/screws not supplied. Bolt holes in 3" and 4" clips are not countersunk.

Chamfering and de-burring tools



Description	Product code
3/8" to 1" pipe inner and outer milling cutter tool	FT 55 72 90
3/8" to 2" pipe inner and outer milling cutter tool	FT 55 65 12
3/4" to 6" chamfering tool	FT 55 05 10

Pipe cutters



Description	Product code
3/8" to 2" pipe cutter	FT 80 00 01
1 1/2" to 4" pipe cutter	FT 80 00 03
3/8" to 2" spare cutter wheel	FT 80 00 02
1 1/2" to 4" spare cutter wheel	FT 80 00 04